

The logo for KEYA, featuring the word "KEYA" in a stylized, white, geometric font. The letters are interconnected, with the 'K' and 'E' sharing a vertical stroke, and the 'Y' and 'A' sharing a vertical stroke. A registered trademark symbol (®) is located at the top right of the 'A'.

UNLOCK INNOVATION

Abstract white lines on a blue background. The lines form a series of overlapping, curved shapes that resemble a stylized wave or a series of parallel paths that curve and intersect. The lines are thin and white, creating a sense of motion and depth against the solid blue background.

TRONIC PRO



## Multuser mode

1

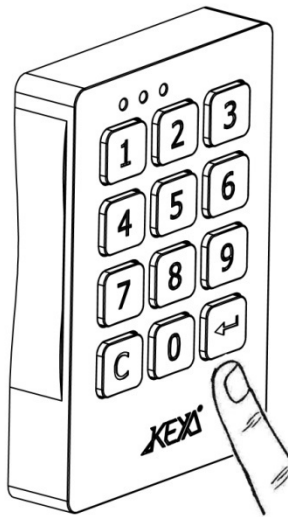
**To close:****To open:**

Open and close by 4-digit code. The code is erased every time the lock is opened, being available for a new use.

## Single User mode

2

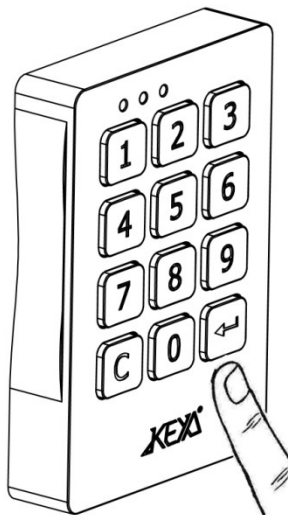
**To open:****To close:**

The latch closes automatically after 2 seconds.  
Note: the lock is provided with a metal latch holder that allows to close the door just by pushing it. (slam door system)

Open and close by 4-digit code. The code is set for 1 user only.

### Change the User code

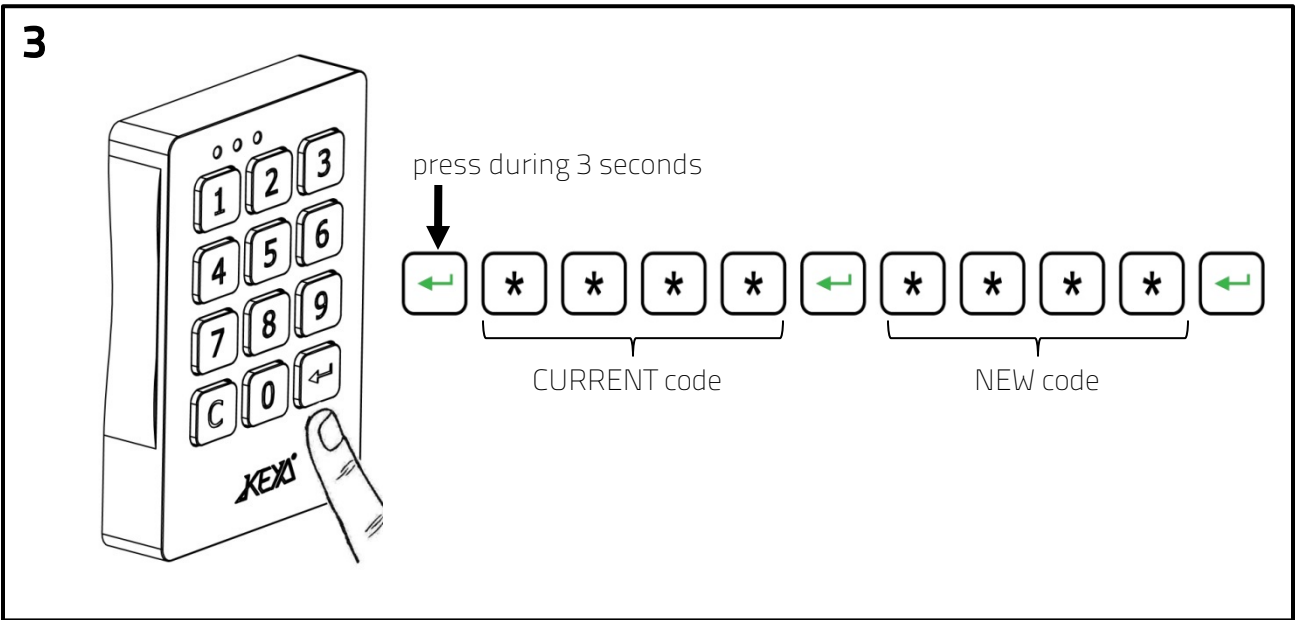

Press Enter during 3 seconds.  
 Introduce Current code and press Enter.  
 Introduce New code and press Enter.

### Open using Master code: Inspection mode / Delete User code

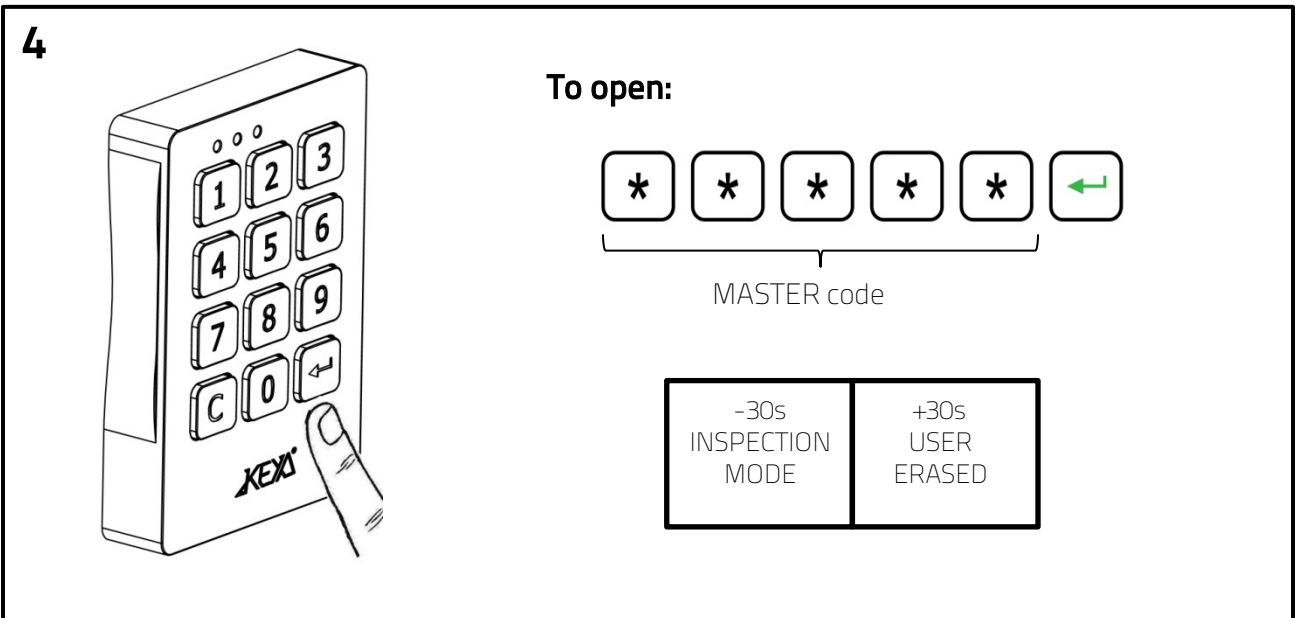

**INSPECTION MODE**  
 Introduce the 5 digit Master code and press Enter  
 Close the lock by pressing Enter before 30s.  
 The User code is not deleted.

**DELETE USER CODE**  
 Introduce Master code and press Enter.  
 After 30s the lock remains opened.  
 The user code has been deleted and a new  
 User code will be required to close the lock  
 again.

## Change the Master code

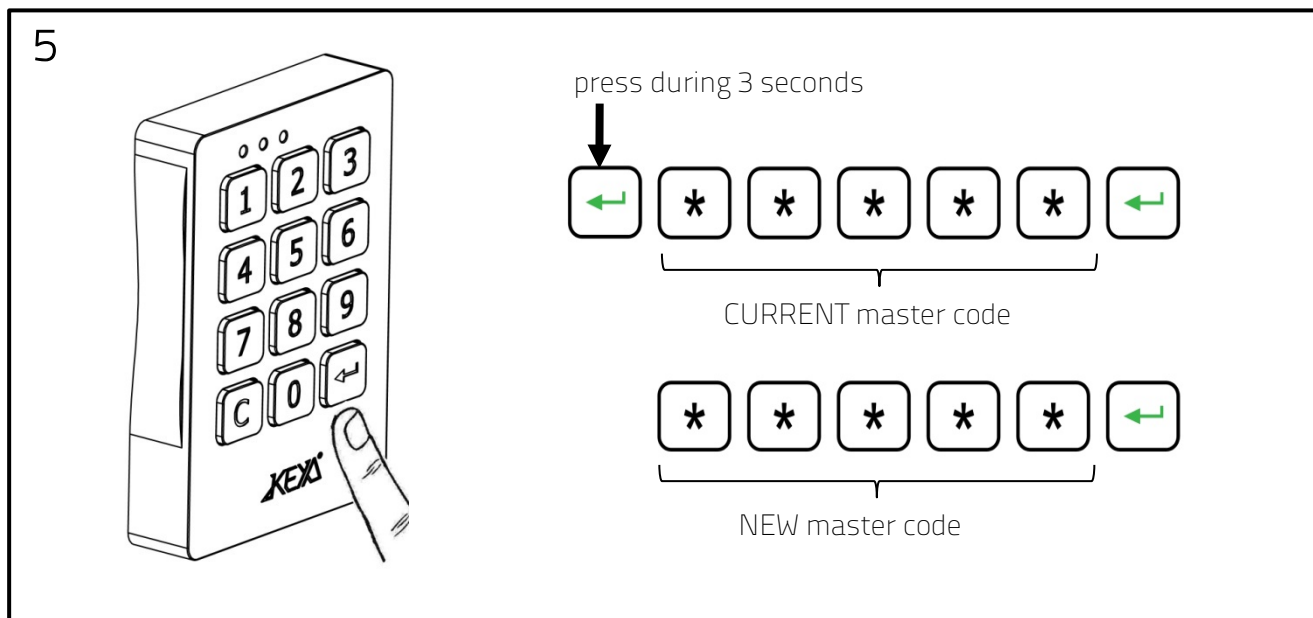

Press Enter during 3 seconds.  
 Introduce Current master code and press Enter.  
 Introduce New master code and press Enter.

## Open using electronic Master key: Inspection mode/ Delete User code

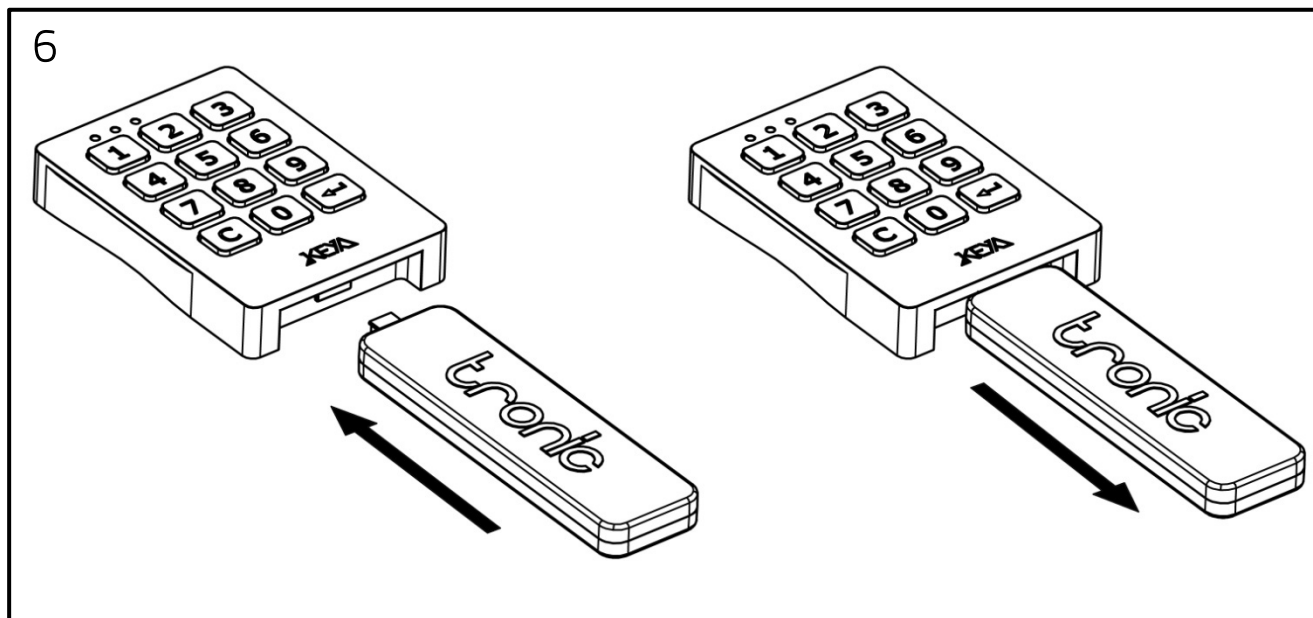

### INSPECTION MODE

Connect the Master key (BLUE)  
 Lock opens  
 Remove electronic key  
 Press enter before 30 seconds  
 User code is not deleted.

### DELETE USER CODE

Connect the Master key (BLUE)  
 Lock opens  
 Remove electronic key  
 After 30 seconds the User code will be deleted.  
 A new User code will be required to close the lock again.

## Programmable settings ( management software and cable required )

### AUTOMATIC OPENING TIME:

The lock will open automatically at the programmed time:

- hh : mm
- Mon, Tue, Wed, Thu, Fri, Sat, Sun
- Working days
- Two options: Leave door open  
Close door again

### ACOUSTIC SIGNAL VOLUME:

- High / Low / Off

### LED INDICATION OF CLOSED POSITION:

- On / Off blinking red LED when locker is closed

### CODES:

- User / Master

### LAST EVENTS

### BATTERY LEVEL

### N° OF OPERATIONS

## Settings key

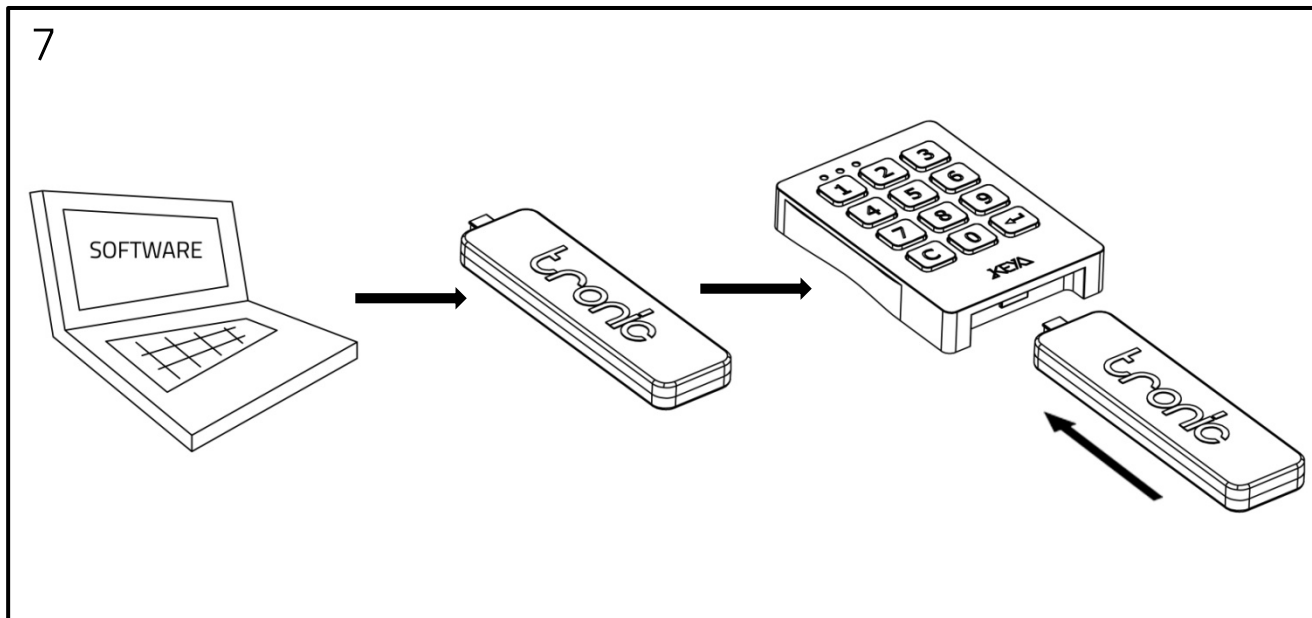

Load settings from the computer to the settings key (BLACK)

Connect settings key to the lock.

The settings will be automatically transferred to the lock.

### Batteries replacement

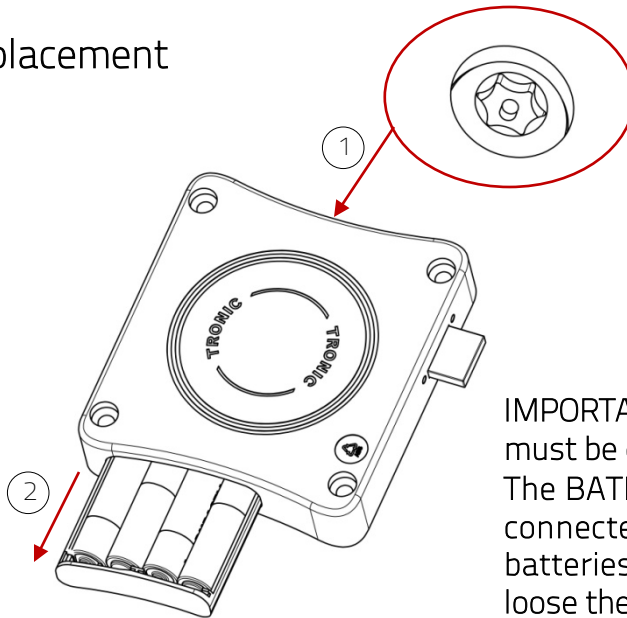

Torx T20

**IMPORTANT:** The batteries replacement must be done in less than 5 minutes. The BATPACK must remain connected during the release of the batteries (otherwise the clock will lose the programmed time).

### Measurements

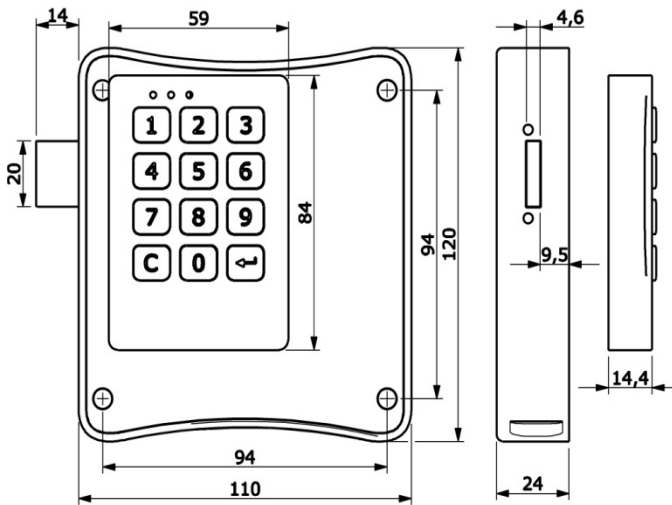

### Technical specifications

Salt spray test	> 96h
Working temperature	-5° C < > +70° C
Latch force	> 45Kgf
UV Rays	> 10000h
Vibration	10 - 200 Hz 2g
Life test	> 200000 cycles
Electrostatic discharge	8000 V
Battery life	> 70000 cycles



RoHS



Management System  
ISO 9001:2008

www.tuv.com  
ID: 9105066651

